

Uniclass L811	EPIC Q12
Cl/SfB (90.7) X	

Product Catalogue 2009



Introducing an exciting, revolutionary range
of urban furniture for the 21st century

introducingurbanscape



"The most important people we know – our customers have increased in their numbers over the years, and we're confident that their ranks will expand even further during 2009. What makes us so sure is that the four cornerstones of our business – innovation, pride, quality and style, will always meet the new demands for enhancing public spaces."



Urbanscape accept all major credit and debit cards:



urbanfurnitureformodernliving

If you're looking for inspiration, it's here – with products packed with practicality and versatility. Add to this exceptional service, delivered with pride, and it's easy to see why Urbanscape remain as first choice for improving the public and civic environment.

Take a Seat – In a Clean Environment

Helping our customers to provide a relaxed, pristine and stylish outdoor environment is an important part of Urbanscape's commitment. That's why we've developed such a wide variety of seating – our attractive bench models, such as the Carsington, Chatsworth, Haddon and Brunel ranges, are all designed to upgrade and enhance public spaces and individual sites. These are fully complemented by an exceptional choice of litter bins to match any requirement – from double-skinned and single skinned models to steel bins, grit bins and those all-important dog waste bins – and we're proud of our bespoke litter bins. Just give us your specifications, and we'll come up with exactly what you need. These are just a few examples of how we're always in the vanguard of new developments.

As the population begins to experience an increasing enjoyment in their civic public spaces, our new and increasing ranges of quality street furniture will continue to expand. As ever, Urbanscape's mission is to continue to present a sense of style and panache with all our British-made products – always the best, always the most competitively priced.

You'll see what we mean by browsing through these pages, but always remember – if what you're searching for isn't here, let us know and we'll find it. Tell us the time, and the place – and it'll be there!

contents



p4 cigarette disposal bin



p7 cigarette bansigns



p8 litter disposal



p20 doggy doo bin



p24 grit/storage bins



p26 outdoor noticeboards



p30 rotational moulded bollards

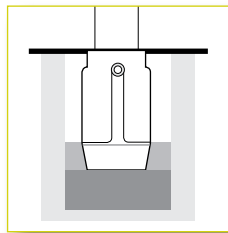

p34 fixing options



p36 materials & properties



p38 PU bollards



p44 classic bollards

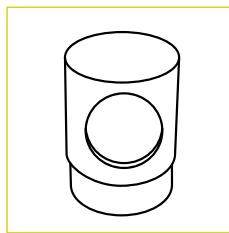

p45 modular bollards



p46 seating



p54 picnic benches



p56 urbanscape terra-lock®



p58 flags & banners



p60 peripherals



p62 christmas lights



p64 bespoke services



p66 customisation range

cigarette disposal bin

a definite must for no smoking areas

Giving Benefits

- ✓ Non-corrosive
- ✓ Easy installation
- ✓ Tough anti-failure lock
- ✓ No maintenance needed

Urbanscape manufacture a range of hard-wearing Cigarette Disposal Bins specifically designed to combat the increased problem of cigarette litter in our urban environment.

If you have a **NO SMOKING** policy you will need one of these...

USL-Cigarette Disposal range

Ideal for use inside or outside your no smoking office, no smoking factory, no smoking pub, no smoking hotel, designated smoking area or no smoking restaurant. Prevents unsightly littering and ash dirt associated with cigarette butts, outside the entrance door to your premises.

The USL-Cigarette Disposal range is fitted with an anti-failure lock system, making it clean and easy to empty.

What do I do checklist

Employers, managers and those in charge of smoke-free premises and vehicles will need to:

- **Display 'no smoking' signs in smoke-free premises**
- **Take reasonable steps to ensure that staff, customers/members and visitors are aware that premises and vehicles are legally required to be smoke free**
- **Ensure that no one smokes in smoke-free premises or vehicles**



cigarette disposal bin

a warm welcome awaits smokers and non-smokers alike

filthy facts:

IF EVERY SMOKER DROPPED ONE CIGARETTE BUTT EACH WEEK IN THE UK, WE WOULD BE KNEE DEEP IN MORE THAN 624 MILLION CIGARETTE ENDS WITHIN A YEAR

AN ESTIMATED 122 TONS OF CIGARETTE BUTTS AND CIGARETTE-RELATED LITTER IS DROPPED EVERY DAY ACROSS THE UK

OVER 90% OF ENGLAND'S STREETS ARE BUGHTED WITH CIGARETTE ENDS, CIGARETTE PACKETS AND MATCHES

CARELESS SMOKING IS ESTIMATED TO BE THE NUMBER ONE CAUSE OF FIRE RELATED DEATH AND INJURY IN THE UK



Embassy - Robust wall or post mounted Cigarette Bin to keep areas clean of cigarette ends and cigarette ash.

Available in mild steel only, coated in Tough Tex, black. Providing good resistance to corrosion.

LARGE 2 LITRE CAPACITY
QUICK & EASY TO EMPTY
RECYCLABLE
TOUGH AND DURABLE

ref: u-embassy/ms



The Player - Keep your smoking areas free from cigarette ends and ash with this sturdy, lockable bin.

Available in mild or stainless steel. No need to touch the contents with the simple emptying system.

LARGE 2 LITRE CAPACITY
NON-CORROSIVE
TOUGH ANTI-FAILURE LOCK
RUGGED BRUSHED STEEL SHELL

ref: u-player/ms
u-player/ss



Super King - Suitable for internal, external & under cover use.

Available in mild or stainless steel. The large door area on your cigarette bins can also carry your advertising from sponsors or businesses.

ENORMOUS 2.5 LITRE CAPACITY
LARGE STUB PLATE
RECYCLABLE
MOULDED-IN COLOUR
NO LITTER FIRES

ref: u-super king/ms
u-super king/ss



The Marlboro - Keep your smoking areas free from cigarette ends and ash with this enormous capacity lockable bin.

Available in mild or stainless steel. Ideal for public areas where smoking is prevalent.

GIGANTIC 7 LITRE CAPACITY
NON-CORROSIVE
TOUGH ANTI-FAILURE LOCK

ref: u-marlboro/ms
u-marlboro/ss

cigarette disposal bin

a definite must for no smoking areas

Urbanscape floor standing cigarette bins are stylish, functional and are easily fixed to the floor for public areas where a wall mounted unit cannot be used.

The Urbanscape Nubber stands 870mm high and has a massive capacity and as you can see, can be easily emptied with out the need to touch those filthy nubs.

The Urbanscape Freestand has been developed with all our other wall mounted cigarette bins in mind. Choose the cigarette bin you would like then just add the versatile Freestand. Easy as that, good job well done.

The Freestand is 1300mm high and like the Nubber is easily fixed to the floor.



US-Nubber

With convenient access for easy waste disposal



US-Nubber

US-Freestand

cigarette bansigns

legally required no smoking signs - ensure you comply

Avoid possible fines by displaying Smoking Ban compliant signage. All Urbanscape signs are compliant with Smoking Ban legislation.

Use cigarette ban signs to assist your implementation of the smoking ban. Available in 3 materials: self-adhesive vinyl for indoor use. 2mm rigid plastic for outdoor use - fixings required, and self-adhesive Rigid Plastic for use on any smooth indoor surface or company vehicles.

All signs are available in 3 standard sizes:

A5 – 210 (H) x 148mm (W), A4 – 297 (H) x 210mm (W), A3 – 420 (H) x 297mm (W)



No smoking



You are entering a no smoking zone



No smoking. It is against the law to smoke in these premises



Smoking is not permitted on these premises



No smoking. It is against the law to smoke in these premises except in a designated room



No smoking



This a no smoking vehicle:
Double Sided Vehicle Label



Brushed Steel Plaques



The NEW brushed steel plaques are ideal for pubs, clubs, hotels and restaurants giving your establishment a more 'classy' feel.

Also available in various text options on request.

litterdisposal

with a wide range of practical modifications

Giving Benefits

- ✓ Tough tamper-free lock
- ✓ Clean, modern design
- ✓ Great for logos
- ✓ Choice of finishes

Here's a smart, simply designed durable option for litter disposal, the bright, shiny stainless steel USL-Stainless 100 L.

It's economical, secure with it's own locking system giving easy access to the liner.

This is a no-nonsense bin with clean lines which will enhance any public place offering a practical solution with grace and economy.



USL-Stainless 100 L



Aesthetically pleasing – This stylish and practical bin will provide protection from the elements all year round

Options – Choice of sizes available 100/240 litre



Visit us online@
www.urbanscapeuk.com

stainlesssteelbins

with a wide range of practical modifications



Easy access to liner
Through practical door arrangement



Tough solid liner
With convenient handles for easy waste disposal



Safe and secure
Comes with special, robust lock



Keep the vandals out
You have your own key

USL-Stainless 100 L

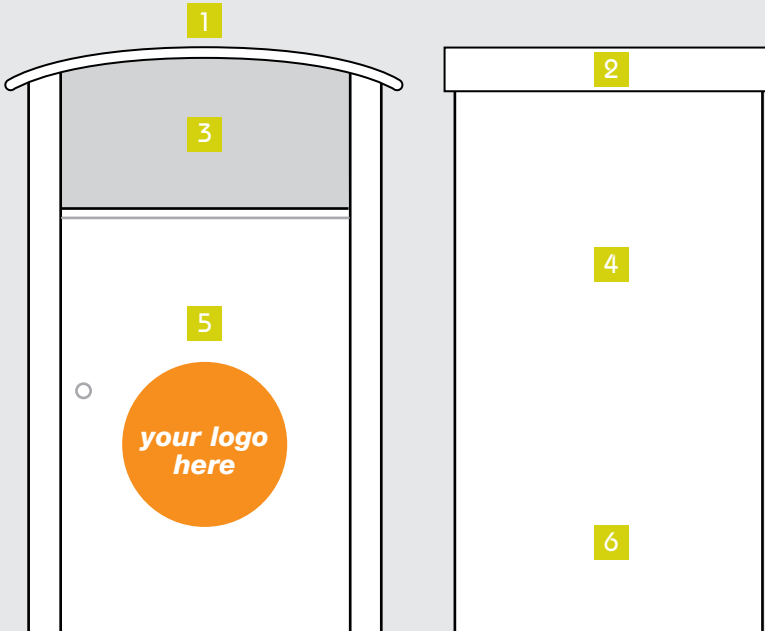

1. Sensibly designed curved top
2. Strong and weather resistant
3. Plenty of access space for litter
4. Large capacity – 100/240 litre
5. Sizeable surface areas for branding/graphics
6. Optional lacquer coating
7. Stability and strength when anchored

pointsofinterest

7



Information on the customisation range can be found on pages 66 & 67



ALL URBANSCAPE products use recyclable materials

URBANSCAPE The Nursery, Penfold, Hulland Village, Derbyshire DE6 3EQ, United Kingdom
T: 01335 372785 | F: 01335 372786 | E: info@urbanscapeuk.com | W: www.urbanscapeuk.com

litterdisposal

stylish, contemporary and superbly practical

Giving Benefits

- ✓ Durable
- ✓ Rugged construction
- ✓ Ideal for logos/crests
- ✓ Choice of colours

There's nothing humble about a practical Urbanscape litter bin or waste disposal receptacle. We believe in style – we want pride on your high street, and our designs inspire it.

The USL 100 range: the ultimate solution to litter disposal. Durable, rugged construction, packed with customising possibilities, with an optional front plate to display your logo. Matching your corporate identity is no problem – the range comes in an excellent variety of colours.

Maybe you have design initiatives beyond our innovative bins. Our bespoke service welcomes your ideas – whatever you're looking for, call us – we'll put your potential to work.



USL 100



Fixable Base – Easily detachable for removal from site



Information on the wide colour spectrum can be found on page 31

USL100

polyethylene twin skin range



Double waste entry as standard
Easily detachable lid for emptying
Cigarette stubber as standard



Micro-Recycle option
Ideal for can disposal



USL 100 TwinBin
Easily fastened and detached



Security fixing plate
Temporary or permanent enclosure

USL 100



1. Cigarette stub plate as standard or micro-recycle entry option
2. Twin skin polyethylene lid for maximum strength
3. Large diameter waste entry
4. 100 litre capacity - liner included
5. Your corporate branding: mould-in graphic or vinyl transfer
6. Twin skin polyethylene casing for increased durability. Anti fly-post lacquer coating option available
7. Square base with ballast for exceptional stability

pointsofinterest



Information on the customisation range can be found on pages 66 & 67



ALL URBANSCAPE products use recyclable materials

URBANSCAPE The Nursery, Penfold, Hulland Village, Derbyshire DE6 3EQ, United Kingdom
T: 01335 372785 | F: 01335 372786 | E: info@urbanscapeuk.com | W: www.urbanscapeuk.com

litterdisposal

with a wide range of practical modifications

Giving Benefits

- ✓ Durable
- ✓ Lightweight
- ✓ Ideal for logos/crests
- ✓ Choice of colours

Sadly, some public areas can be more vandal-prone than others. When it comes to installing litter disposal bins in such places, you no longer need to face the cost and replacement risk of using our more sophisticated range.

Urbanscape now have this sturdy, single-skin bin which will do the job economically – it's smart, and won't break the bank if it needs replacing.



USL 100 B



Fixable Base – Easily detachable for removal from site

Options – Available with or without lid



Information on the wide colour spectrum can be found on page 31

USL100B

with a wide range of practical modifications



Visit us online@
www.urbanscapeuk.com



Removable solid liner

Complete with handles for quick & easy waste disposal

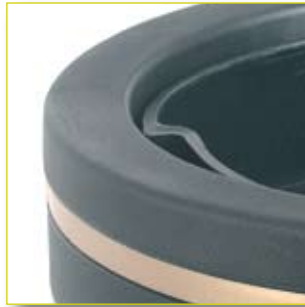

Single skin 100 litre capacity bin

Anti fly-post lacquer coating option available



Branding

Your council/company logo can be displayed on the outer surface of the bin



Available with or without lid

Choose between the large diameter waste entry lid or without!

USL 100 B



1. Cigarette stub plate as standard or micro-recycle entry option
2. Single skin polyethylene lid for maximum strength
3. Large diameter waste entry
4. 100 litre capacity - liner included
5. Your corporate branding: mould-in graphic or vinyl transfer
6. Single skin polyethylene casing for increased durability. Anti fly-post lacquer coating option available
7. Large round foot print giving maximum stability

pointsofinterest



Information on the customisation range can be found on pages 66 & 67



ALL URBANSCAPE
products use
recyclable materials

URBANSCAPE The Nursery, Penfold, Hulland Village, Derbyshire DE6 3EQ, United Kingdom
T: 01335 372785 | F: 01335 372786 | E: info@urbanscapeuk.com | W: www.urbanscapeuk.com

litterdisposal

with a wide range of practical modifications

Benefits Include

- ✓ Rugged construction
- ✓ Corrosion resistant
- ✓ Ideal for logos/crests
- ✓ Choice of colours

If you want to frustrate the vandals – here's the answer. The USL-Steel 100 L is made from heavy gauge steel. The sturdy door hangs on a virtually indestructible hinge arrangement.

Corrosion resistant and durable it's polyester powder-coated and available in a range of colours.



USL-Steel 100 L



Easy Access – 4 spacious apertures for litter

Indestructible – Door cannot be forcibly removed

Options – Choice of sizes available 100/240 litre



Information on the wide colour spectrum can be found on page 31

steelbins

with a wide range of practical modifications



Removable solid liner
Easily accessible liner allowing speedy disposal



Virtually indestructible
Virtually indestructible door hinge system



Access
4 litter posting apertures



Personalisation options
Ideal for company/council logos or graphics

USL-Steel 100 L

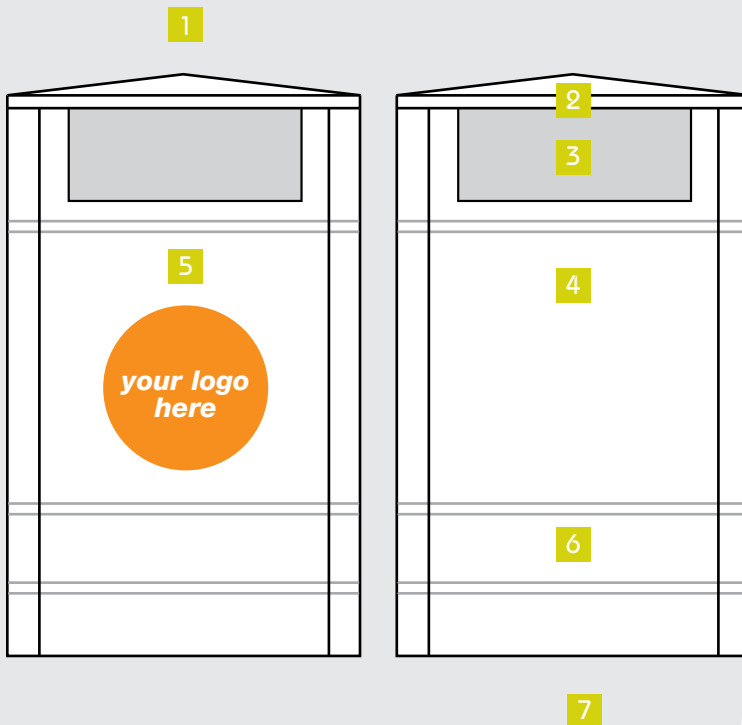

1. Optional cigarette stubbing plate with galvanised ashtray drawer
2. Hefty, durable lid
3. Generous waste openings
4. Large capacity – 100/240 litre
5. Perfect for corporate branding using either transfers or moulded graphic
6. Durable, vandal-defeating casing with optional anti-fly poster coating
7. Stable heavy duty base

pointsofinterest



Information on the customisation range can be found on pages 66 & 67

megabin

big, strong and economical

Giving Benefits

- ✓ Sturdy
- ✓ Heavy duty
- ✓ Ideal for logos/crests
- ✓ Choice of colours

Some vandals are more frequent and active in some locations than others. That's when a little economy is required. Using Urbanscape's generously sized, less costly Megabin you can avoid the expense of replacing our more sophisticated range.

The Megabin is sturdy, with an enormous capacity – and ideal for lay-bys or public areas where litter collection is less frequent.



USL-Mega 240 L



Comes with a fixable base – Removal from site made easy

Options – Choice of sizes available



Information on the wide colour spectrum can be found on page 31

megabin

big, strong and economical



Enormous capacity

Ideal for areas of less frequent litter collection



Sturdy hinged door

Door cannot be forcibly removed



Tough locking system

Keeps the bin secure from interference



Cigarette stub plate

Keeps pavements dog-end free

USL-Mega 240 L

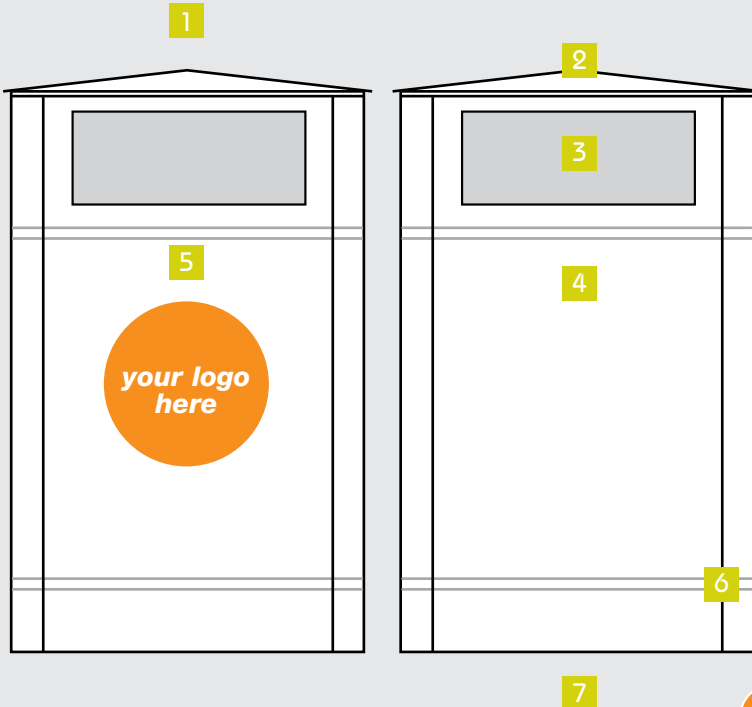

1. Secure top
2. Hefty, durable lid
3. Large diameter waste entry
4. Capacity options – 100/240 litre
5. Your corporate branding: mould-in graphic or vinyl transfer
6. Vandal proof hinges
7. Stable heavy duty base

pointsofinterest



Information on the customisation range can be found on pages 66 & 67



ALL URBANSCAPE products use recyclable materials

URBANSCAPE The Nursery, Penfold, Hulland Village, Derbyshire DE6 3EQ, United Kingdom
T: 01335 372785 | F: 01335 372786 | E: info@urbanscapeuk.com | W: www.urbanscapeuk.com

wall/postmounted

perfect for parks and open spaces

Giving Benefits

- ✓ Sturdy yet lightweight
- ✓ Eye-catching design
- ✓ Ideal for personalisation
- ✓ Choice of colours

Out there in the open greenery you need a bin to blend in sensitively with the environment.

The USL 50 W is just right – it looks equally good neatly fixed to a wall, or standing proud on it's rigged steel post, fixed to a good surface with the innovative Urbanscape Terra-Lock® Ground Anchor plate.

With it's stylish curved top and generous aperture, this is a business-like bin which simply encourages tidiness.

The innovative side opening lid also makes easy emptying when fixed to a wall.



USL 50 W



Easily fixable – Looks good on exterior walls

Neat Opening Top – Hinged with lock

The
URBANSCAPE
Terra-Lock®
Ground Anchor

Information on our unique anchoring system can be found on pages 56 & 57



wall/postmounted

perfect for parks and open spaces



Easily removable liner
Simple open-top access



Secure hood
Strong lock to foil any tampering



Easy cleaning
Hinged top presents easy cleaning access



Optional lid
Large diameter waste entry with or without lid

USL 50 W



1. Distinctive curved hood
2. Tamper-proof with sturdy lock
3. Generously-sized aperture for litter
4. Large capacity 50 litre
5. Neat space for personalisation/ graphic
6. Easy wall fixing or ground installation
7. Strong, durable polyethylene construction



Information on the customisation range can be found on pages 66 & 67

pointsofinterest

doggydoobin

ideal for parks and open spaces

Giving Benefits

- ✓ Tough and durable
- ✓ Easily installed
- ✓ Ideal for logos
- ✓ Choice of colours

We all love man's best friend, so when nature calls responsibility's the answer – and that means Urbanscape's new USL-Doo 50 dog waste bin.

It's perfect for town centres, open spaces and parks, with a large capacity chute for easy waste disposal.

USL-Doo 50

It's as tough and durable as they come, it'll defeat the vandals and with it's permanent surface there's no painting to bother about.

Installing in soft ground presents no problems – forget concrete or digging. With its hard-gripping urbanscape Terra-Lock®, the USL-Doo 50 stays put, and it's easy to re-site the bin when the barb is retracted.

It comes with an option for a steel liner or a sack retention system.



The
URBANSCAPE
Terra-Lock®
Ground Anchor

Information on our unique anchoring system can be found on pages 56 & 57



Information on the wide colour spectrum can be found on page 31

doggydoobin

ideal for parks and open spaces



Safe and secure
Strong lock system prevents tampering



Easy-open top
Quick access and easy cleaning



Innovative fixing system
Easily installed onto posts or the wall



Easy liner disposal
Top opening for easy liner removal

USL-Doo 50



1. Ample chute space for easier disposal
2. Security -Tough lock with key
3. Large access for emptying/ cleaning
4. 50 litre capacity
5. Adequate space for mould-in graphics or logo
6. Rugged durable polyethylene with optional ant-fly-post coating
7. Choice of fixing systems

pointsofinterest



Information on the customisation range can be found on pages 66 & 67



ALL URBANSCAPE
products use
recyclable materials

URBANSCAPE The Nursery, Penfold, Hulland Village, Derbyshire DE6 3EQ, United Kingdom
T: 01335 372785 | F: 01335 372786 | E: info@urbanscapeuk.com | W: www.urbanscapeuk.com

metaldoggydoobin

perfect in parks, superb for open spaces

Giving Benefits

- ✓ All-weather toughness
- ✓ Easy installation
- ✓ Plenty of advert space
- ✓ Choice of colours

If you're looking for something even tougher to deal with the poochy-poo then our USL-Metal Doo 50 bin fits the bill.

It's as tough as they come, a functional piece of simple design, with a 50 litre capacity and a large capacity opening, it's just right for parks and the great outdoors.

USL-Metal Doo 50

Lashing rain or searing heat, this can handle any weather when fitted with a steel liner.

Installing in soft ground presents no problems – forget concrete or digging. With its hard-gripping urbanscape Terra-Lock®, the USL-Metal Doo 50 stays put, and it's easy to re-site the bin when the barb is retracted.

It comes with an option for a steel liner or a sack retention system. Also available in larger sizes.



The
URBANSCAPE
Terra-Lock®
Ground Anchor

Information on our unique anchoring system can be found on pages 56 & 57



Information on the wide colour spectrum can be found on page 31

metaldoggydoobin

perfect in parks, superb for open spaces



Sturdy hinged top

Allowing easy liner removal and cleaning



Removable liner

Hassle-free removal and replacement of liners



The Pooch-Hook!

Keep Fido in his place whilst you're scooping!



Rugged self-returning lid

Keeps the elements at bay

USL-Metal Doo 50

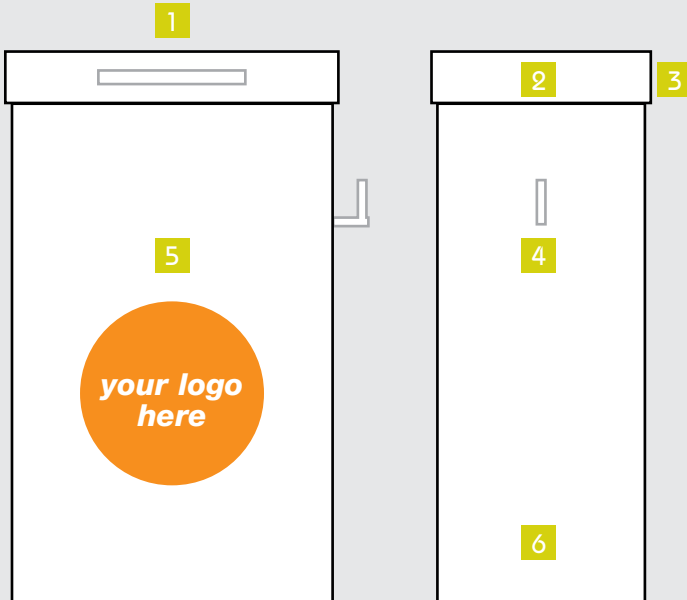

1. Practical, strong handle for easy opening
2. Well-made lid for protection against the weather
3. Large sized access to liner
4. Hook to keep an eye on your dog
5. Adequate space for corporate branding
6. Strong steel means maximum durability. With optional anti-fly post lacquer

pointsofinterest



Information on the customisation range can be found on pages 66 & 67

grit/storagebins

tough, secure and weatherproof

We never expect that cold snap but when it comes we need to be ready. Urbanscape know the importance of smart, secure and durable grit and salt bins, and we have the very best to complement our growing range of products.

Manufactured in tough, medium density polyethylene, our range of tough grit and salt bins are ideal for roadside storage, company premises and car parks.

The hinged lid protects the grit and salt from the elements, and a range of colours, including yellow, red and environmental green is available. Our bins will not discolour!



USGB 400 litre capacity
USGB 200 litre capacity also available

USL-GS 70



USL-GS 70 litre capacity

Grit spreader – This handy piece of kit will face up to everything the British weather can throw at it! It's ideal for public parks and open spaces, car parks or company premises.



Control panel
For all types of surface stability



Smooth running
Convenient handling for those hard to reach places



Information on the wide colour spectrum can be found on page 31

grit/storagebins

tough, secure and weatherproof



Tough, medium density polythene
Ideal for roadside storage, company premises and car parks



Hinged top feature
Protects the grit and salt from the elements



Sturdy design
Highly practical in busy urban environments



Sturdy Lock & key
Lockable hood to prevent unauthorised access

USGB Range

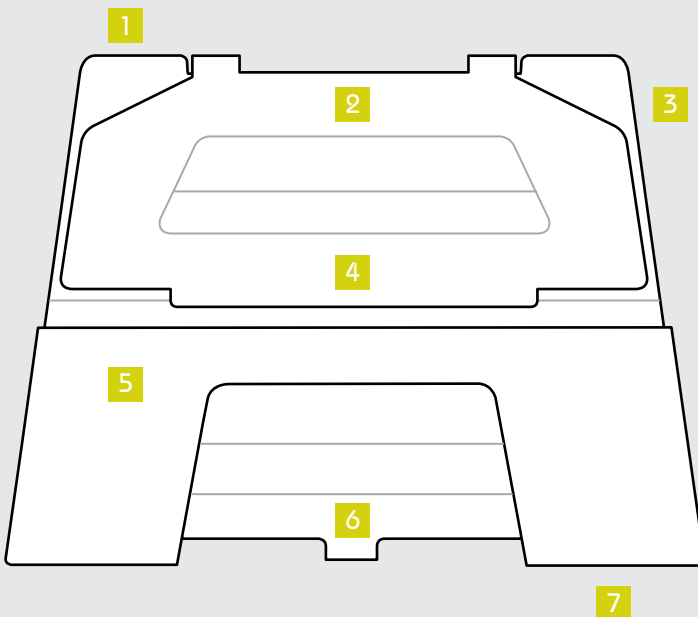

1. Hinges for extra strength and protection
2. Weather resistant self-returning lid
3. Large, easy access opening
4. Convenient handle gives instant access
5. Plenty of corporate branding space
6. Polyethylene casing for increased durability
7. Sturdy base for exceptional stability

pointsofinterest



Information on the customisation range can be found on pages 66 & 67



ALL URBANSCAPE
products use
recyclable materials

URBANSCAPE The Nursery, Penfold, Hulland Village, Derbyshire DE6 3EQ, United Kingdom
T: 01335 372785 | F: 01335 372786 | E: info@urbanscapeuk.com | W: www.urbanscapeuk.com

woodennoticeboards

pointing your people in the right direction – in style!

Notice boards need not be brash, too basic or indistinct. They should point the way with elegance and simplicity and complement the hard work you have carried out to make your civic environment as friendly and inviting as it can be.





Also available in a range of soft woods: *Bare wood, Tanalised, Sapele and Iroko.*

woodennoticeboards

pointing your people in the right direction – in style!

All Urbanscape notice boards come with a wide range of practical modifications.



Hinged doors

For easy access to your information



Single step bevel top detail

Decorative bevelled posts add to the elegance of the design



Lockable doors

Protects the notice/information from the elements with added security



USNB Wooden



Information on the customisation range can be found on pages 66 & 67



ALL URBANSCAPE
products use
recyclable materials

URBANSCAPE The Nursery, Penfold, Hulland Village, Derbyshire DE6 3EQ, United Kingdom
T: 01335 372785 | F: 01335 372786 | E: info@urbanscapeuk.com | W: www.urbanscapeuk.com

composite noticeboards

pointing your people in the right direction – in style!



USNB Composite / 8 A4

The 'parish box' notice board is manufactured in a strong and durable composite that can be matched to almost any colour. The eye catching design is available in 3 sizes: 2 A4, 4 A4 and 8 A4 options. The rear face has two metal 50mm wide strips that are moulded onto the structure and run across the backface enabling a wide range of fixing points.

The units also have extra security in the form of corner locks which help secure the units against unwanted vandalism.

compositenoticeboards

pointing your people in the right direction – in style!



Hinged doors

For easy access to your information



Safe and secure

Added security to protect from any vandalism



Bevel top detail

Decorative bevelled edges add to the elegance of the design



Display case

Flexible cork back panel for safe information change

For practicality Urbanscape also offer this product in a range of sizes to suit your bespoke needs.

All Urbanscape notice boards come with a wide range of practical modifications.



USNB Composite / 4 A4



USNB Composite / 2 A4



Information on the wide colour spectrum can be found on page 31



Information on the customisation range can be found on pages 66 & 67



ALL URBANSCAPE products use recyclable materials

URBANSCAPE The Nursery, Penfold, Hulland Village, Derbyshire DE6 3EQ, United Kingdom
T: 01335 372785 | F: 01335 372786 | E: info@urbanscapeuk.com | W: www.urbanscapeuk.com

A row of black rotational moulded bollards with gold bands is installed on a cobblestone sidewalk next to a street. The bollards are arranged in a line, receding into the distance. The background shows a street with buildings and a clear sky.

rotational moulded bollards

Urbanscape bollards for unrivalled site control

Urbanscape manufacture a range of hard-wearing Rotational Moulded Bollards specifically designed for rural, urban and heritage areas. The range come with a variety of fixing, banding, colour & signage options, and reflective options.

rotational moulded bollards

specification range

Signage options (optional)

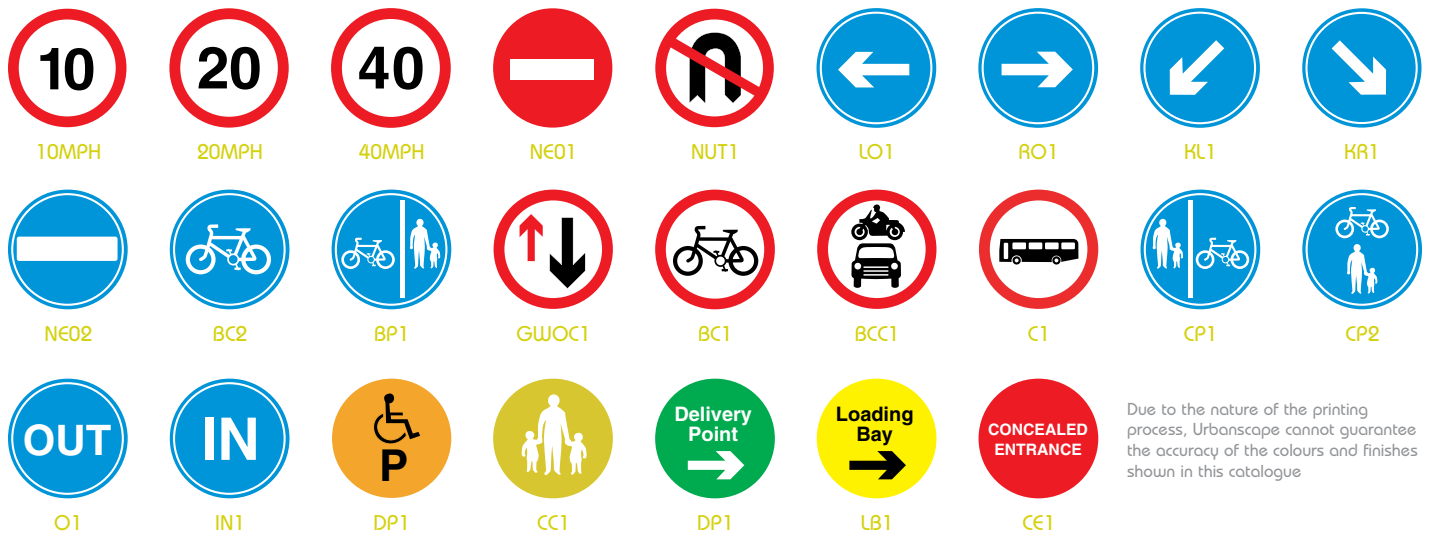

Colour specifications

Standard colours

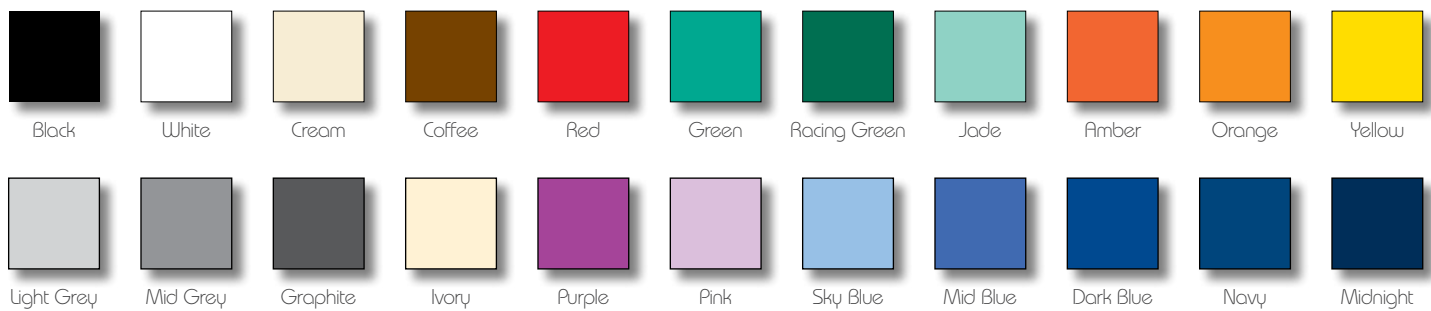

These maintenance – free products have their solid body colour permanently moulded in. They can be supplied in non-standard colours matching the following systems:

NCS-Natural Color System® is an international colour standard for specifiers, manufacturers and industry. Widely used for coatings, laminates, cladding, etc.

The Munsell Colour-Order System® is a way of precisely specifying colours and showing the relationships among colours, establishing numerical scales with visually uniform steps for each of colour's attributes.

The AAL DESIGN System has been developed for professional colour design. It contains 1688 colors arranged in a systematical order.

Pantone® is the world-renowned authority on colour and provider of colour systems and leading technology for the selection and accurate communication of colour.

rotational moulded bollards

a comprehensive range



Lolli - Non-corrosive, recyclable and maintenance free this versatile range of low-level durable plastic bollards carries signs both standard or non-standard.

IDEAL FOR SPEED WARNINGS, CYCLE AND PEDESTRIAN ROUTES

MOULDED-IN COLOUR

NO MAINTENANCE NEEDED

RECYCLABLE

TOUGH AND DURABLE

RANGE OF APPROVED SIGNAGE TOPS

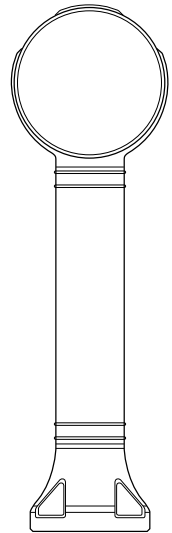

4-Way - Don't worry about bumping that bollard! Perfect for those hazardous sites where regular bollards are vulnerable and need frequent replacement.

NON-CORROSIVE

TOUGH SHATTERPROOF REFLECTORS

NO MAINTENANCE

RUGGED UV MOULDED POLYETHYLENE

MOULDED-IN COLOUR

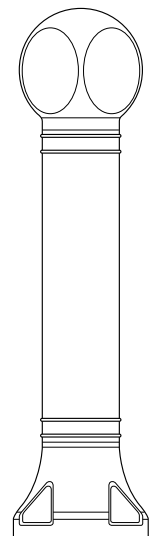

rotational moulded bollards

a comprehensive range



Dometop - Safety is the keyword with this superior bollard. Its clearly visible in those dark, poorly-lit places. High quality reflective banding makes this ideal for installation in accident black spots, or in traffic calming schemes.

HIGHLY REFLECTIVE

NO MAINTENANCE REQUIRED

CHOICE OF APPROVED SIGNS

REFLECTIVE BANDING PROTECTED BY RECESSED AREAS

RECYCLABLE

MOULDED-IN COLOUR

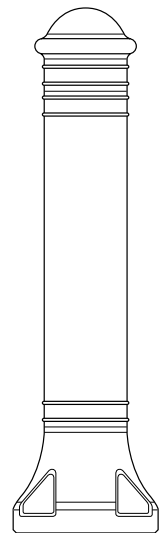

2 Way - High quality no rust, no maintenance bollard. Ideal for a variety of urban and traffic environments. The 2 Way is also suitable for hazard marking and anti-ram.

NON-CORROSIVE

TOUGH SHATTERPROOF REFLECTORS

NO MAINTENANCE

RUGGED UV MOULDED POLYETHYLENE

MOULDED-IN COLOUR

RANGE OF APPROVED SIGNAGE TOPS

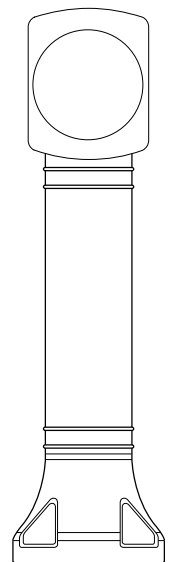

ALL URBANSCAPE
products use
recyclable materials

URBANSCAPE The Nursery, Penfold, Hulland Village, Derbyshire DE6 3EQ, United Kingdom
T: 01335 372785 | F: 01335 372786 | E: info@urbanscapeuk.com | W: www.urbanscapeuk.com

rotational moulded bollards

available in a range of 4 ground fixing options

SOCKETED

Bollard removal and replacement? 4 Easy Stages!

1. Dig the right sized hole to match your bollard. Bed it with type 1 infill, and make sure that the top of the socket levels with the final ground level.
2. Using concrete mix, part-fill the hold around the socket, into which you now place the bollard. Lock it by twisting clockwise.
3. Add more concrete until 100mm below final ground level. Using the key provided, unlock the bollard and take it from the socket whilst waiting for the concrete to cure.
4. Complete the hole to final ground level, replace the bollard and lock it to the socket.

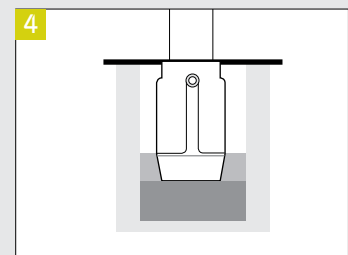
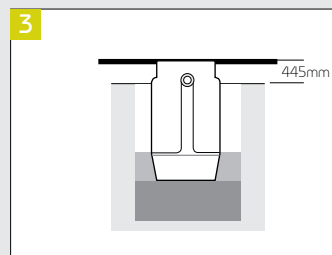
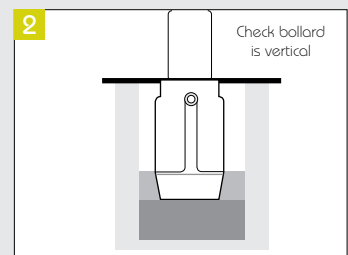
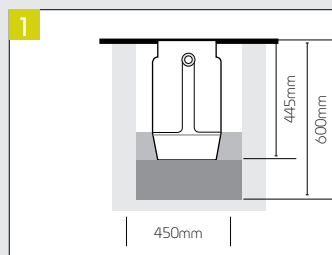

SURFACE

Bridges, parks or multi-storey car parks may have vulnerable below-ground surfaces. In this event the bollard is fixed with 95mm expanding bolts using a shallow concrete substrate.

1. Place your bollard in position. If it's fitted with reflective banding, make sure it can be viewed in the traffic flow - red on the left hand roadside, white on the right.
2. Use a masonry drill whilst the bollard's in position and mark the 4 bolt positions on the wearing surface; remove the bollard, drill your holes.
3. Position the bollard again, then through the base, place the expanding bolts into your drilled holes and tighten them.

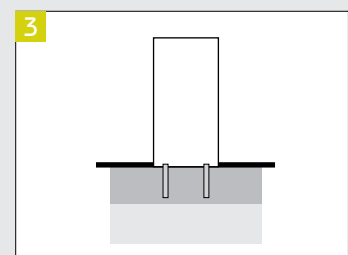
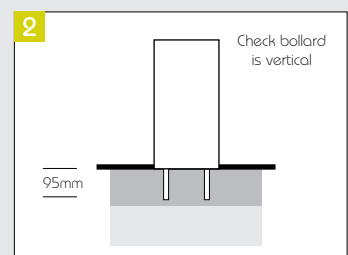
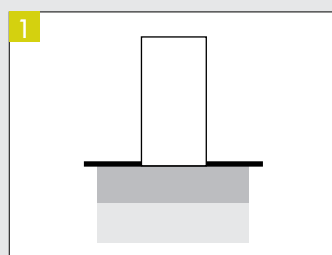

rotational moulded bollards

available in a range of 4 ground fixing options

ANTI-RAM

It's immovable - solidly concreted into the ground, a rugged steel core will give any potential ram-raider a nasty shock.

1. Once you've dug the correct-sized hole and bedded it with Type 1 infill, onto your compacted hardcore you sit the steel tube. To check that your bollard is flush with ground level, slide it over the tube.
2. Use concrete mix to fill the hole around the steel tube - make sure that the concrete penetrates the holes to enter the tube.
3. Take the three provided spring clips and space them equally around the top edge of the tube.
4. Slide the bollard over the tube. To fit the locking screw, simply drill a hole through the tube, place the screw and tighten it. Fit the supplied blanking cap and repeat these stages for the other screw port.

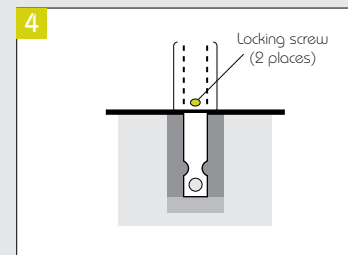
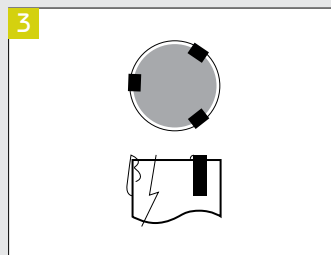
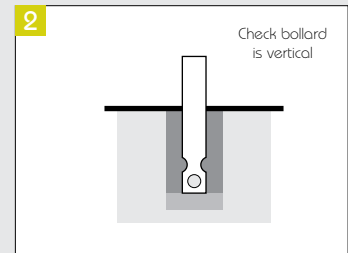
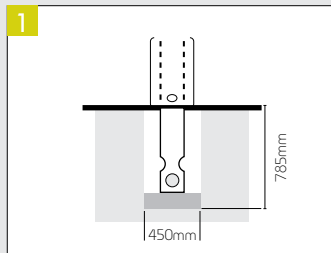

PERMANENT

For a bollard which can't be removed, the base is concreted below ground, with the moulded return and the base ensuring permanent fixing.

1. Bed your correct sized hole with Type 1 infill and make sure that your bollard plinth base is at final ground level.
2. For a bollard fitted with reflective banding, make sure it can be viewed in the traffic flow - red on the left hand roadside, white on the right. Use concrete mix to part-fill the hole.
3. Add more concrete to 100mm below final ground level. Once your concrete has cured, make good to final ground level.

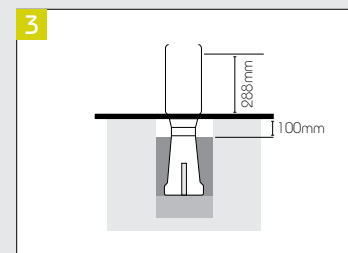
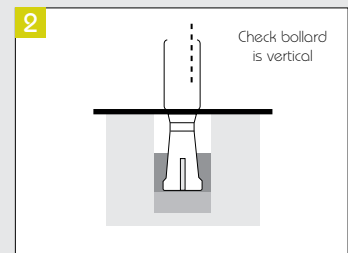
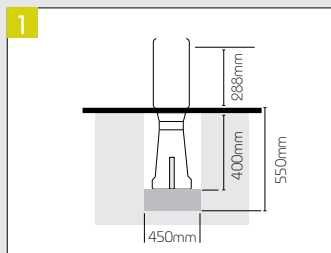

ALL URBANSCAPE
products use
recyclable materials

URBANSCAPE The Nursery, Penfold, Hulland Village, Derbyshire DE6 3EQ, United Kingdom
T: 01335 372785 | F: 01335 372786 | E: info@urbanscapeuk.com | W: www.urbanscapeuk.com

rotational moulded bollards

materials & properties



Reflective Materials – For improved bollard visibility, Engineering Grade, High Intensity and Diamond Grades are all available, so both bollards and bins can be customised to your choice of reflective properties.



Recycling – The Environment Agency's accredited standards can be met with our 100% recyclable polyethylene – and we can offer further environmentally friendly products in 100% post-consumer recycle.



Colour Specification – You've a wide choice of colours for products using all the accredited colour systems, including NCS-Natural Color System®© theRAL Design system The Munsell Colour-Order System® Pantone®



Durability – Impact-resistant, ruggedly tough and durable moulded polyethylene is shatterproof and strong against any fracture, it's mechanical properties Tested to BS 2782.



Maintenance Free – No painting to worry about – the permanent solid body colour is moulded in. Resistance against wear and tear leaves scrapes from vehicles or scratches unnoticed.



All Weather Resistance – Weather in the Northern Hemisphere is demanding – but polyethylene can stand up to all the elements.



Cleaning – It's easy – a flush over with clean water followed by a solution using mild detergent. Taking care not to use too much pressure, carefully use a bristle brush or sponge to avoid damaging labels, then another flush with water – job done!



Resistance to Chemicals – PE can't be corroded by diesel fumes, acid rain, soot, seawater or salt. Polyethylene resists them all.



Manufacturing Standard – All products are manufactured to BS EN ISO 9002, and mechanical properties of plastic products to BS 2782. Zinc coated: BS 1706, Powder coated: BS 3900, and hot dipped galvanised to BS 729.

rotational moulded bollards

materials & properties

Urbanscape's Rotational Moulded Bollards

have many remarkable properties with a truly wide range of applications.

Wherever there's a high standard to aim for, we'll reach it, to provide the best possible product to enhance any chosen location.

Every aspect is covered, including strength, durability and absolute weather resistance. These products are the result of years of research and development to achieve the ultimate in practical functional street furniture which is easy to maintain and simple to install or re-locate – and the environmental options such as re-cycling are a very important 21st century element which takes pride of place in our design.



If a custom made scheme is required see our bespoke services on pages 64 & 65



Reflective Properties

	Description	Applications	Benefits
Engineering Grade	Meets requirements of BS:873 Part 6 (Class 2 signs) with Enclosed lens retro-reflective sheeting	General signage including permanent road traffic signs, street nameplates and emblems	Impressive reflective performance – easily legible and bright 24 hours per day, with a performance life of 7 years
High Intensity	Meets requirements of BS:873 Part 6 (Class 2 signs) with Encapsulated lens retro-reflective sheeting	General signage including permanent road traffic signs, street nameplates and emblems	Impressive reflective performance – 3.5 times brighter than Engineering Grade (Class 2), with an effective performance life of 10 years
Diamond Grade	Highly retro-reflective sheeting provides. Visual Impact Performance	Ideal for road traffic signs with short to medium viewing distances – especially in areas where high ambient background lighting is prevalent	Offers a reflective performance approximately 3 times brighter than High Intensity (Class 1), with a 12 year effective performance life providing excellent daytime colour definition and exceptionally high night-time brightness

pubollards

ideally suited to today's urban environment

Giving Benefits

- ✓ Durable
- ✓ Colour stability
- ✓ Simple installation
- ✓ No residual value

Cast iron bollards are rapidly giving way to a new generation of robust, ruggedly constructed PU bollards. Their tough durability is just what's needed in the modern urban landscape. Just check out the advantages these Polyurethane Elastomer have to offer and you'll see why they're streets ahead of the old traditional bollards.

1. STREET WISE



2. MANCHESTER



3. MANCHESTER SLIM



4. MORPETH



5. SLOUGH



6. PLYMOUTH





Information on the wide colour spectrum can be found on page 31

pubollards

ideally suited to today's urban environment

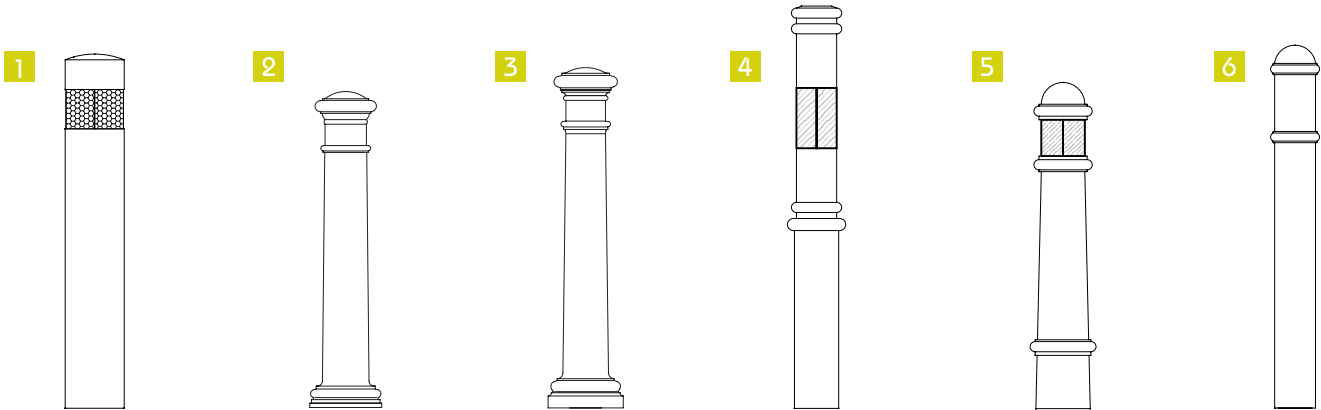

1 Streetwise - Central steel tubular core incorporating anchor plates for secure installation. Outer covering is a heavy-duty elastomeric polymer, Ultrathane® 100 in 97A hardness.

TOTAL WEIGHT 16-23Kg
HEIGHT ABOVE GROUND 900mm-1000mm
ROOT DEPTH 300mm

2 Manchester - Cast in Ultrathane 6000. Fully pigmented and finished in polyurethane paint. Incorporating integral mild steel core and anchoring bar.

TOTAL WEIGHT 22.5Kg
HEIGHT ABOVE GROUND 965mm
ROOT DEPTH 300mm

3 Manchester Slim - Cast in Ultrathane 6000. Fully pigmented and finished in polyurethane paint. Incorporating integral mild steel core.

TOTAL WEIGHT 20.3Kg
HEIGHT ABOVE GROUND 955mm
ROOT DEPTH 300mm

4 Morpeth - Cast in Ultrathane 6000. Fully pigmented and finished in polyurethane paint. Incorporating integral mild steel core. Complete with 150mm diamond grade reflective tape located between rings.

TOTAL WEIGHT 15.8Kg
HEIGHT ABOVE GROUND 1000mm
ROOT DEPTH 300mm

5 Slough - Cast in Ultrathane 6000. Fully pigmented and finished in polyurethane paint. Incorporating integral mild steel core and anchoring bar. Complete with 1/2 red 1/2 white diamond grade reflective tape.

TOTAL WEIGHT 19.4Kg
HEIGHT ABOVE GROUND 900mm
ROOT DEPTH 300mm

6 Plymouth - Cast in Ultrathane 6000. Fully pigmented and finished in polyurethane paint. Incorporating integral mild steel core and anchoring bar.

TOTAL WEIGHT 10.5Kg
HEIGHT ABOVE GROUND 800mm
ROOT DEPTH 300mm

pubollards

ideally suited to today's urban environment

A variety of styles offers you a broad choice of bollards. They're as tough as they are attractive, with styles to match the ambience of any location, either traditional or ultra-modern. They have many advantages over the older cast iron versions, yet still retain all the grace of the old designs as well as offering something new for today's surroundings.

7. BURY/BLACKPOOL



8. DELAVAL



9. EXETER



10. BARNSTAPLE



11. NAPOLI



12. SEAHAM





Information on the wide colour spectrum can be found on page 31

pubollards

ideally suited to today's urban environment

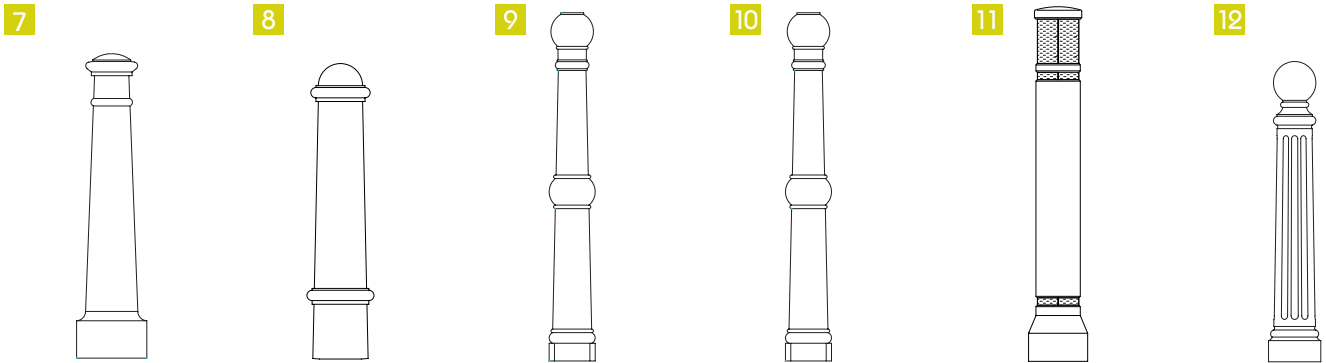

7 **Bury/Blackpool** - Cast in Ultrathane 6000. Fully pigmented and finished in two pack polyurethane paint. Incorporating integral mild steel core, anchoring bar and white diamond grade reflective tape.

TOTAL WEIGHT 17.0Kg
HEIGHT ABOVE GROUND 815mm
ROOT DEPTH 300mm

8 **Delaval** - Cast in Ultrathane 6000. Fully pigmented and finished in polyurethane paint. Incorporating integral mild steel core, anchoring bar and red diamond grade reflective tape strip on one side and white on the other.

TOTAL WEIGHT 16.2Kg
HEIGHT ABOVE GROUND 800mm
ROOT DEPTH 300mm

9 **Exeter** - Cast in Ultrathane 6000. Fully pigmented and finished in polyurethane paint. Incorporating integral mild steel core and anchoring bar.

TOTAL WEIGHT 14.0Kg
HEIGHT ABOVE GROUND 983mm
ROOT DEPTH 300mm

10 **Barnstaple**- Cast in Ultrathane 6000. Fully pigmented and finished in polyurethane paint. Incorporating integral mild steel core and anchoring bar.

TOTAL WEIGHT 14.0Kg
HEIGHT ABOVE GROUND 983mm
ROOT DEPTH 300mm

11 **Napoli** - Cast in Ultrathane 6000. Fully pigmented and finished in polyurethane paint. Incorporating integral mild steel core, anchoring bar and 1/2 red, 1/2 white diamond grade reflective tape.

TOTAL WEIGHT 31.8Kg
HEIGHT ABOVE GROUND 1200mm
ROOT DEPTH 300mm

12 **Seaham** - Cast in Ultrathane 6000. Fully pigmented and finished in polyurethane paint. Incorporating integral mild steel core and anchoring bar.

TOTAL WEIGHT 12.0Kg
HEIGHT ABOVE GROUND 900mm
ROOT DEPTH 350mm

pubollards

ideally suited to today's urban environment

Urbanscape's PU Bollards come in designs to fit any period. If you've a Heritage location to furnish, then you'll find a bollard to suit the mood. They have all the strength and charm of their cast iron predecessors, and the contemporary versions will be a welcome addition to the 21st century urban scene.

13. LORRY PARK



14. BATH



15. BOROUGH



16. WESTERN-SUPER-MARE



17. HEXHAM



18. FOLKSTONE





Information on the wide colour spectrum can be found on page 31

pubollards

ideally suited to today's urban environment

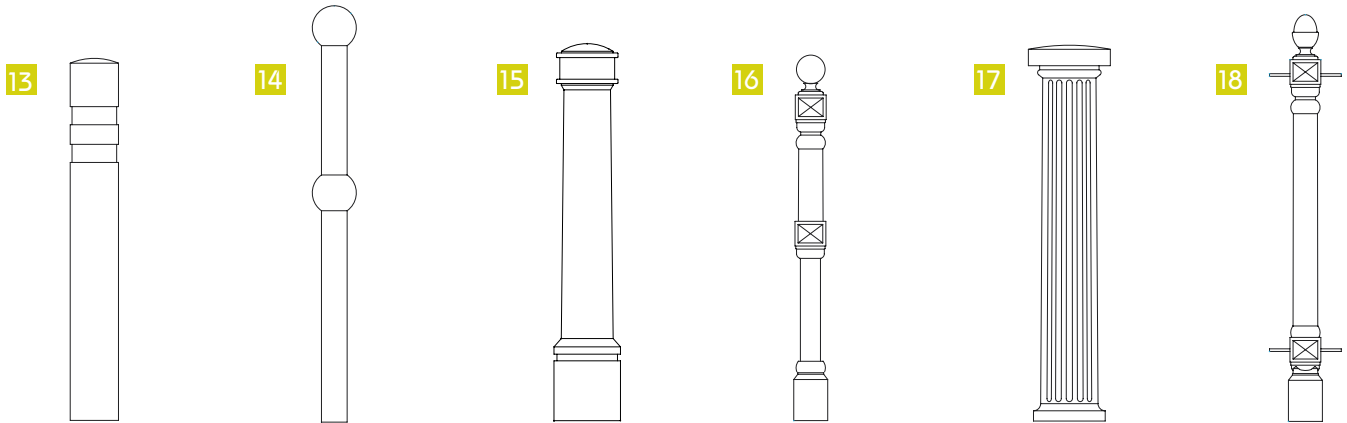

13 **Lorry Park** - Cast in Ultrathane 6000. Fully pigmented and finished in polyurethane paint with two bands. Incorporating integral mild steel core and anchoring bar.

TOTAL WEIGHT 43.0Kg
HEIGHT ABOVE GROUND 1200mm
ROOT DEPTH 600mm

14 **Bath** - Cast in Ultrathane 6000. Fully pigmented and finished in polyurethane paint. Incorporating integral mild steel core and anchoring bar.

TOTAL WEIGHT 10.6Kg
HEIGHT ABOVE GROUND 1135mm
ROOT DEPTH 300mm

15 **Borough** - Cast in Ultrathane 6000. Fully pigmented and finished in polyurethane paint. Incorporating integral mild steel core and anchoring bar. Top section to have red/white diamond grade reflective material.

TOTAL WEIGHT 31.6Kg
HEIGHT ABOVE GROUND 1134mm
ROOT DEPTH 300mm

16 **Western-Super-Mare** - Cast in Ultrathane 6000. Fully pigmented and finished in polyurethane paint. Incorporating integral mild steel core and anchoring bar.

TOTAL WEIGHT 10.5Kg
HEIGHT ABOVE GROUND 1260mm
ROOT DEPTH 300mm

17 **Hexham** - Cast in Ultrathane 6000. Fully pigmented and finished in polyurethane paint. Incorporating integral mild steel core and anchoring bar.

TOTAL WEIGHT 17.0Kg
HEIGHT ABOVE GROUND 917mm
ROOT DEPTH 300mm

18 **Folkstone** - Cast in Ultrathane 6000. Fully pigmented and finished in polyurethane paint. Incorporating integral mild steel core and anchoring bar.

TOTAL WEIGHT 15.5Kg
HEIGHT ABOVE GROUND 1300mm
ROOT DEPTH 300mm



If a custom made scheme is required see our bespoke services on pages 64 & 65

classicbollards

your imagination + our inspiration: result? innovation!

Urbanscape's inventive capacity knows no bounds – whatever your budget, we've built a product range to match – plus a reputation for innovation...

Our products provide decoration – and security. Whatever you're searching for, we have it – if not, anything's possible – we'll find it! Maybe you have a bollard in mind made in a specific material. It doesn't have to remain a vague idea – Urbanscape deals in reality. All we need is a drawing or a rough sketch. Let us develop the product – just leave everything to us.

Low maintenance is the key today. We're ahead of the game with a contemporary blend of style and security, with minimum maintenance. Perhaps you're looking for decorative durability – and that means our range of steel bollards – will last.

There's a variety of head materials and shapes on offer. Timber heads can be in Iroko with an oiled finish. The square head is also available as an aluminium casting which can be powder-coated in a clear or coloured finish.

Square cast heads can have 24mm diameter rope or 44 diameter aluminium rails attached using fixing plates. Other options on the heads include the integration of traffic signs.

Fixing the bollards to the ground is easy. Expansion bolts can be used with a plate welded to the tube for fixing to concrete surfaces. The surface fixed option has a cast collar which hides the fixings, and this is available in clear or coloured powder coat finish.



USL-RSF
Galvanised mild-steel / single-step finial



USL-SSS
Stainless steel / square / single-step



USL-RAC
Stainless steel / round / angle-cut



USL-RTS
Stainless steel / round / triple-step



USL-SAC
Stainless steel / square / angle-cut



USL-SSS-BEV
Timber / bevel top / single-step



USL-SSS-SQU
Timber / square top / single step

- Bespoke solutions with the design, size, material, finish, fixing and even the message you need
- Damage-proof
- Removable for security and access restriction
- Embed in concrete for sturdiness
- Integral part of the Urbanscape range

modularbollards

restrict, guide and direct your patrons in style

Headoptions

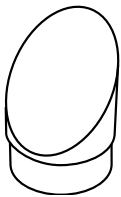

Mitre

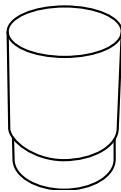

Cylinder

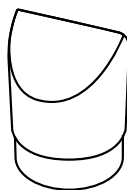

Arrow

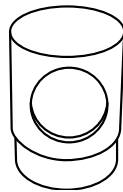

Cylinder signage*

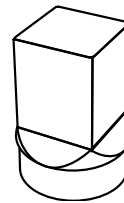

Square*

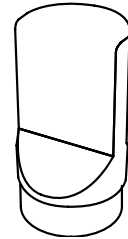

Semi-circular*

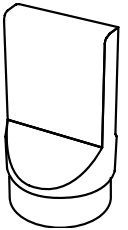

Plane*

Headmaterialoptions

Due to the nature of the printing process, Urbanscape cannot guarantee the accuracy of the colours and finishes shown in this brochure



Cast aluminium



Stainless steel



Hardwood



Yellow powder coated



Black powder coated

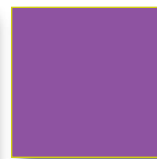

Violet powder coated



Blue powder coated



Red powder coated

Dimensionoptions

Diameter	Height
100mm	425mm 600mm 1000mm
150mm	425mm 600mm 1000mm

The information displayed is intended to outline the standard bollard options available. Urbanscape are also able to design and produce bollards to your own specification, please contact us to discuss your specific requirements.

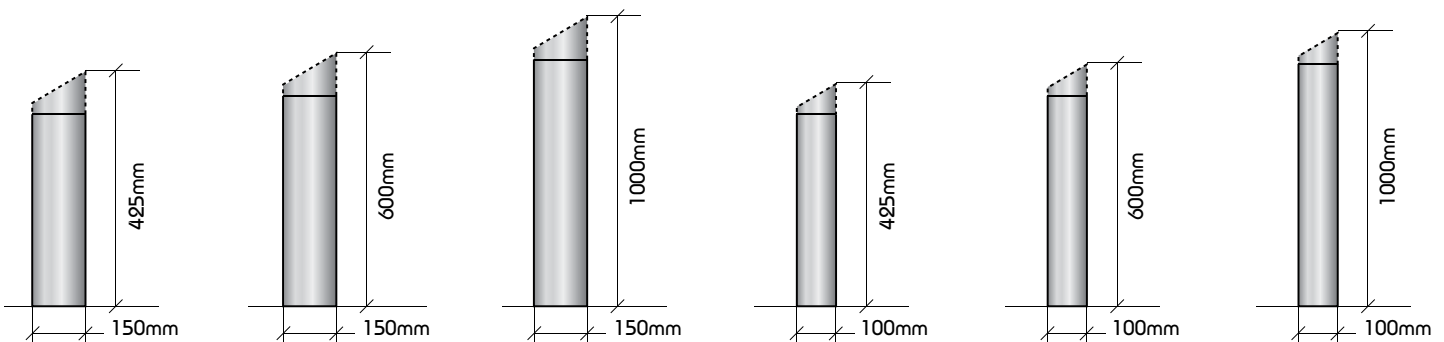

seating

the urbanscape seating range just got bigger... and better!

Good seating in an urban environment is a civilised hallmark of any welcoming town centre or public space. Urbanscape have put a lot of thought into this important subject to come up with designs which embody all the qualities you'll need; style, durability, and above all, comfort.



USWP-S1250

seating

the urbanscape seating range just got bigger... and better!

As you can see, our expanded range of benches and seats are made to suit any environment. We've sought out the best timbers, the finest stainless steel and aluminium, and incorporated these into a superb selection of designs.



USWPS

There's a welcoming, traditional feel to our wholesome wooden planter seats where you can be as close as you wish to those attractive floral displays.

With hardy timbers to survive the seasons, rugged steel fixings and frames and tamper-free screws, an Urbanscape bench is the best place ever to pause and watch the world go by...



seating: the classique range

simplicity with a hint of continent

Beauty, rugged elegance and comfort means the Classique bench. With smart, shiny cast aluminium legs, feet and framing for extra strength, and tamper-free fixing bolts, this is the crème de la crème of civic seating.



The Classique Range
Timber slatted seat with extruded polished aluminium framework

the buster range

hard-wearing and functional - in buster we trust!

You can trust a Buster! The backrest can be removed to form a backless bench, and the multi-metal tubular legs and optional oil-finished Iroko timber give this inviting bench a hard-wearing functionality which graces any public area.



The Buster Range
Timber slatted seat with wide tubular multi-metal legs (backrest optional)



seating:therhinorange

robust simplicity



The Rhino Range
Robust steel bench

Put it anywhere and this tough, simply-designed bench can only enhance the environment. This is a quality bench built to last, as strong and robust as they come.

thenauticarange

simple style and functionality

With optional straight or graceful curved contours, the enticing Nautica bench is a unique focus of style and design. The powder-coated, steel end supports can be supplied in your chosen colour adding an attractive seating arrangement to any public area.

The Nautica Range
Contoured timber top with powder-coated corrugated steel support



seating:theenviorange

furniture to match your flowers and decorative planters



The Environ Range
Timber slatted seat with tubular powder coated stainless steel legs

Everyone will want to rest a while on this attractive, timber slatted seat. The strong, steel legs are powder-coated, painted in the colour of your choice – with a unique feature – by removing the grub screws on the feet you can fit your own crest or logo.

seating:thecarsingtonrange

warm wood, comfort and strength



The Carsington Range

Sturdy, modern lines with the comforting warmth of wood make the Carsington Range a restful focus in any public space. The graceful sides and supports are powder-coated in black making this the ideal seat to take the weight from weary feet.

seating:thechatsworthrange

elegance, durability and restful appeal



The Chatsworth Range

With its familiar, traditional feel the Chatsworth Range has an elegance all of its own.

Strength, durability and a relaxing appeal can be combined here with your choice of powder-coated colour, all of which provides an excellent seat on which to unwind.



ALL URBANSCAPE
products use
recyclable materials

URBANSCAPE The Nursery, Penfold, Hulland Village, Derbyshire DE6 3EQ, United Kingdom
T: 01335 372785 | F: 01335 372786 | E: info@urbanscapeuk.com | W: www.urbanscapeuk.com

seating: the haddon range

a seat and a bench with strength and style

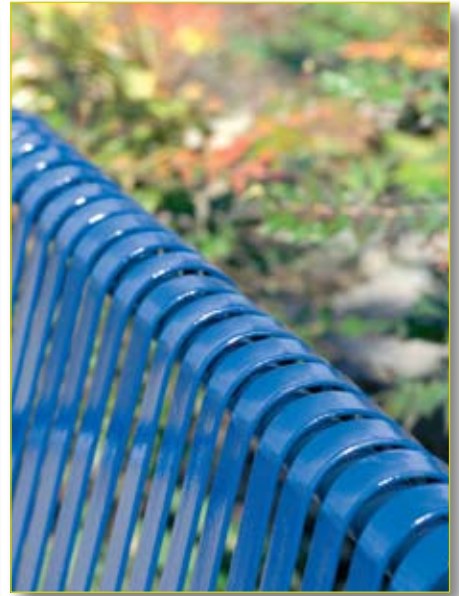

The Haddon Range

Innovative design imbues the Haddon Range of a vigorous sense of strength, and with its attractive, supplementary bench following the same creative features, with your choice of powder-coated colour. This is seating with style, enough to attract any pedestrian in need of a break.

seating:thebrunelrange

traditional comfort, ultimate relaxation



The Brunel Range

Echoes of sophisticated engineering provide the Brunel Range with a consoling sense of time-honoured comfort with a design featuring steadfast embellishments which hark back to a more relaxed age. This fine seat and its attractive accompanying bench will add grace to any public space.

picnicbenches

durable al fresco dining

The quality of some Al Fresco furniture leaves a lot to be desired. That's why Urbanscape have yet again gone back to the drawing board to come up with benches which not only double the pleasure of a picnic – they also stand up against the demanding weather conditions you can expect in the Northern hemisphere.

So forget warping, loose joints, rickety fixings and moss, these are picnic benches and tables built for both comfort and durability. Our selection of three picnic bench units are as tough and solid as they come – better still, they're a solid investment.

- Choice of rugged, treated hardwood traditional styling, looks good, feels good and easy to maintain
- Steel versions are virtually indestructible, weather resistant and available in galvanised powder coating
- All benches are made to accommodate wheel chairs
- All benches can be made smaller for children's seating



Traveller's Rest
Hardy steel bench, galvanised with choice of powder-coated colours



Information on the wide colour spectrum can be found on page 31

picnicbenches

ideal for the great outdoors



The Al Fresco

Galvanised steel, choice of powder coated colours plus maximum stability with 'A' frame design



The Woodsman

Solid, warm treated hardwood with 'A' frame design – a tough piece of outdoor tradition



ALL URBANSCAPE products use recyclable materials

URBANSCAPE The Nursery, Penfold, Hulland Village, Derbyshire DE6 3EQ, United Kingdom
T: 01335 372785 | F: 01335 372786 | E: info@urbanscapeuk.com | W: www.urbanscapeuk.com

urbanscapeterra-lock®

easy to install, easy to remove

The original Terra-Lock® has been used by many organisations, including local authorities, forestry enterprises and well established companies in the civil and security sectors. The applications have varied from litter bins and signs to security applications.

The URBANSCAPE Terra-Lock® Ground Anchor

Ramrod

Fourteen kilograms in weight that delivers an impact sufficient to drive the Terra-Lock® into the most difficult of ground conditions. The ring on the ramrod strikes the top of the anchor and drives it in.

Bin Adaptor

Designed to enable the Urbanscape bin to be fitted to the post of the anchor or directly onto a wall.

Box Spanner

This is used for tightening the M16 nut to lock the Spira-Lock and prevent it from rotating, which stops the Terra-Lock® from coming back out of the ground. To remove the anchor, use the box spanner to loosen the nut to allow the Spira-Lock to rotate freely. The ramrod can then be used in conjunction with the box spanner to remove the Terra-Lock®.

Spira-Lock

This is fixed to the bottom of the socket by way of an M16 stud on the Spira-Lock™ and a nut and washer on the inside of the socket. For installation the nut is tightened sufficiently to just allow the Spira-Lock™ to rotate on the socket.

Socket

Fitted with three stabilising fins that run most of the length of the socket, they provide good lateral and torsional stability.

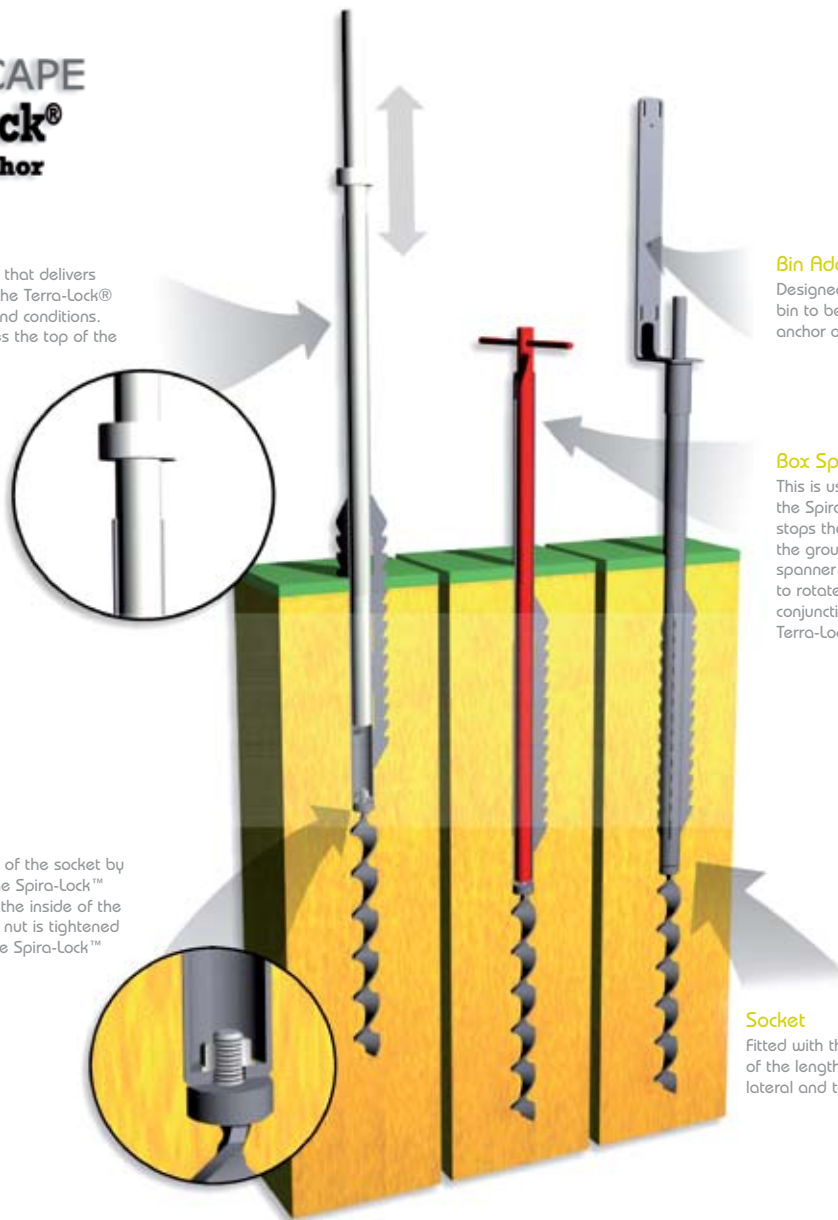

urbanscapeterra-lock®

easy to install, easy to remove

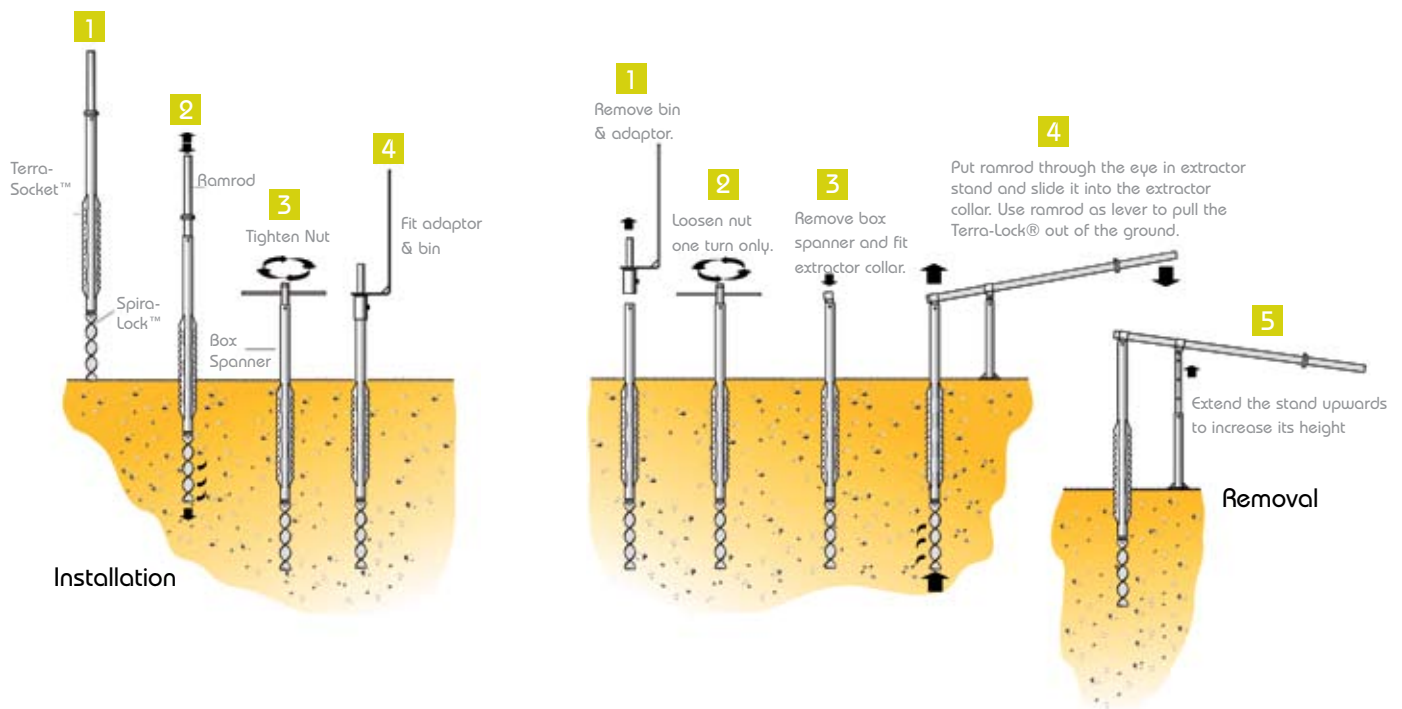

pointsofinterest

- Easy to install, copes with even the most difficult conditions
- Reusable, environmentally friendly and a cost effective alternative to concrete
- Secure, anchor released by use of the box spanner only
- Penetrates most ground conditions including bricks, tree roots and small stones
- Provides good vertical and lateral support
- Heat treated for added strength & corrosion resistance

Urbanscape Terra-Lock® ground anchors can be used for applications such as signs, floor and post mounted litter bins, flagpoles, scaffold type structures where anchoring is required.

The anchors can be fitted with many ancillary items such as steel posts, both square and round, large base plates to take ground mounted items, proprietary adaptors for tubular structures and for shackles. We can also supply sockets designed to take a variety of timber sections for outdoor play equipment.

We can tailor these anchors to suit many individual applications. Should you have such a requirement then please call us and we would be happy to discuss them with you.

flagsandbanners

a popular addition for your big occasion

Unfurl the flags! Here's a new and exciting service from Urbanscape. Flags and banners have been popular throughout Europe for centuries to add a memorable visual splendour for special occasions, festivals and events throughout the year.

Flag and banner poles are now becoming increasingly widespread for this purpose throughout Britain, and Urbanscape can now supply you not only with a colourful range of flags to order, but we can design, manufacture and deliver any banner you need for your big occasion.

Not only will we make them for you, and provide the poles and fittings – we'll even put out the flags on your behalf. Just call us with your requirements, and our team will get to work.

Urbanscape have several flexible ways of providing our banner service.

- We can simply sell you banners and fixings
- Produce artwork, banners, install and remove them to your schedules
- Offer a complete service for a programme of events throughout the year

Which ever way you wish to operate our flags and banners service offers a cost effective one stop shop solution to your problem.



Infosites Information for the public

Inform and advertise with Infosites!

Infosites are made from vandal resistant moulded polyethylene, They are mobile attractive and safe. Infosites are a fantastic way to inform the public of maps, events and notices.

There are three options for using Infosites

- Outright purchase the site and graphics from Urbanscape
- Rental from Urbanscape including installation of the module and a programme of replacement graphics
- As a revenue stream. Urbanscape will install each module at no cost and sell the advertising space. Urbanscape will then repay a percentage of the revenue direct to you



Whatever requirements you have for our Infosites... Urbanscape can offer you a flexible simple and hassle free service.

summary

the very best in 21st century urban furniture – and service!

Urbanscape's growing success in providing new, exciting and contemporary urban furniture products is the result of several elements. One is our feeling for innovation and our constant desire to come up with ideas which improve the environment we all share.

We take into account all those factors which public and corporate organisations are searching for; safety, durability, economy, choice and good design.

Urbanscape continues to forge successfully ahead by seeking out the best new ideas to incorporate into our impressive range of urban furniture. Wherever there's a new innovation to enhance the environment we're onto it – we want you, our customers, to share in our enthusiasm. Safety, durability, economy, choice and good design are all elements both public and corporate organisations aspire to – and that's exactly what we supply.

It's your valuable feedback which keeps us on our toes and ahead of the game. We'll take all the time that's needed to meet our clients and, most importantly – to listen. Urbanscape's team are the most observant in the business – if there's any way we can see a potential improvement in the way your town

centre, public areas or corporate workplace looks, we'll take that idea onto the drawing board and, with your requirements in mind, we'll come up with something new and exciting.

We dedicate ourselves to excellent service. Once your order is placed, we'll never keep you waiting. In a tough, competitive world we're proud to be able to offer a service few can rival – and that's something we're extremely proud of.

So here it is, 68 pages of some of the very best urban furnishings in Europe, chosen and designed with care and attention. Our picnic furniture and seating range is one of the best available. Our litter bins, dog bins and grit bins will admirably complement any public area, All our metal and wood products, from classic bollards to our modular bollards and signage products are the result of careful and inventive thinking – all inspired by you - our customers.

Have browse through the catalogue and never forget - if what you need isn't in these pages, pick up the phone or drop us an e-mail – whatever it is, we'll make it!



peripherals

litter picking made easy

Litter – it’s a nasty habit, but because some folks drop their rubbish then someone has to pick it up. With a good pair of Urbanscape pincers, the task is easier with little bending or back-stretching.

Urbanscape’s strong and practical range of pincers offer the twin benefits of hygiene and total ease of operation. You can ferret out that obstinate bit of litter in the most awkward of places.



USL-EH

- Lightweight sturdy construction
- Smooth, easily operated trigger-grip handle
- Perfect in tight corners or flower beds
- Flexible rubber pincer tips
- 500m, 650mm, or 800mm long



The convenient pads on the pincer ends firmly grip any debris you wish to remove, and respond easily to the smooth trigger-grip action of the handle.

peripherals

litter picking made easy



Wide gripping capability
Handles cans, bottles with ease



Small Items easily removed
Everything, right down to a cigarette end



Safe, hygienic litter handling
Ideal for safe removal of unpleasant debris



Strong easy grip operation
Smooth grip action handle

These Urbanscape Pincers come in three length sizes and are perfect for reaching into the most awkward places. You'll soon get to grips with any litter, from a cigarette butt to a can or a plastic bottle, with the added bonus that your operative will be keeping all the nastiness well beyond arm's length.

The wide jaws on the pincers are easy to operate using the smooth-action grip handle.

- **Versatile gripping capability**
- **Perfect for tight corners, flower beds etc**
- **Safe and hygienic**
- **Plastic tip**
- **650mm, 800mm, or 1000mm long**



USL-6H



christmaslights

bringing joy to the streets



Put a twinkle in your town centre!
Everyone loves seasonal illuminations. They provide pleasure and cheer up any location to take the sting out of the deep mid winter nights. They're low-maintenance and environmentally friendly – they're solar-powered.

pointsofinterest



Own battery pack with full LED lights



Solar backup so no nasty wiring into lamppost



Automatic ON when dark, Off when light



Rental means no capital outlay and no problems with storage



Product with full patents on container and lamppost bracket



Urbanscape's range of Christmas lights covers everything a council or corporate organisation could need to bring joy to their environment.

- Ideal for corporate or civic illuminations
- Low maintenance - choice of applications
- Christmas trees with full fixing kit
- Range of lights for any celebration



christmaslights

bringing joy to the streets



Easy Fixing
In any location



Brightens any town centre
Enhancing all civic buildings



Brightens any town centre
Enhancing all civic buildings



Fully Inclusive Kit
With tree, lights and bracket



Providing illumination all through the night
Christmas tree with full set of solarised lights.
Also incorporate your name, logo or seasonal message.

bespoke services

customer led innovation

Giving Benefits

- ✓ Practicality
- ✓ Versatile
- ✓ Ideal for logos/crests
- ✓ Choice of colours

Urbanscape will meet your original brief and often exceed it to come up with innovative designs which will enhance and add beauty to your public space.

This is achieved through regular communication with our customers and prototype development, the result being practical solutions providing results you can display with pride.

Our bespoke service comes with two important elements – expertise and experience.

As well as the wide range of street furniture products shown in this catalogue, Urbanscape specialise in a bespoke consultation, design and production service. Call now to discuss your latest project, and let Urbanscape point you in the right direction, with solutions to fit your specific project perfectly

- Bespoke solutions with the design, size, material, finish and fixing you need
- Space for mould-in graphics or logo
- Integral part of the Urbanscape range



If you're looking for products in non-standard colours, we can supply them. We can manufacture items utilising the NCS Natural Colour System®, RAL Design System®, Munsell® or PANTONE® or sample references.

All the popular colours and traditional designs are at your disposal, and if you need a bespoke scheme, we're happy to work with your own designers.



Information on the wide colour spectrum can be found on page 31



bespoke services

customer led innovation

There's a lot of creative thinking out there and when your team comes up with something special, Urbanscape's Bespoke Services are at your disposal to help turn those ideas into reality. If not everything you're planning matches the content of our catalogue, that's no problem.

Our team can come up with the right bespoke solution to meet your needs – all it takes is a call or an e-mail.

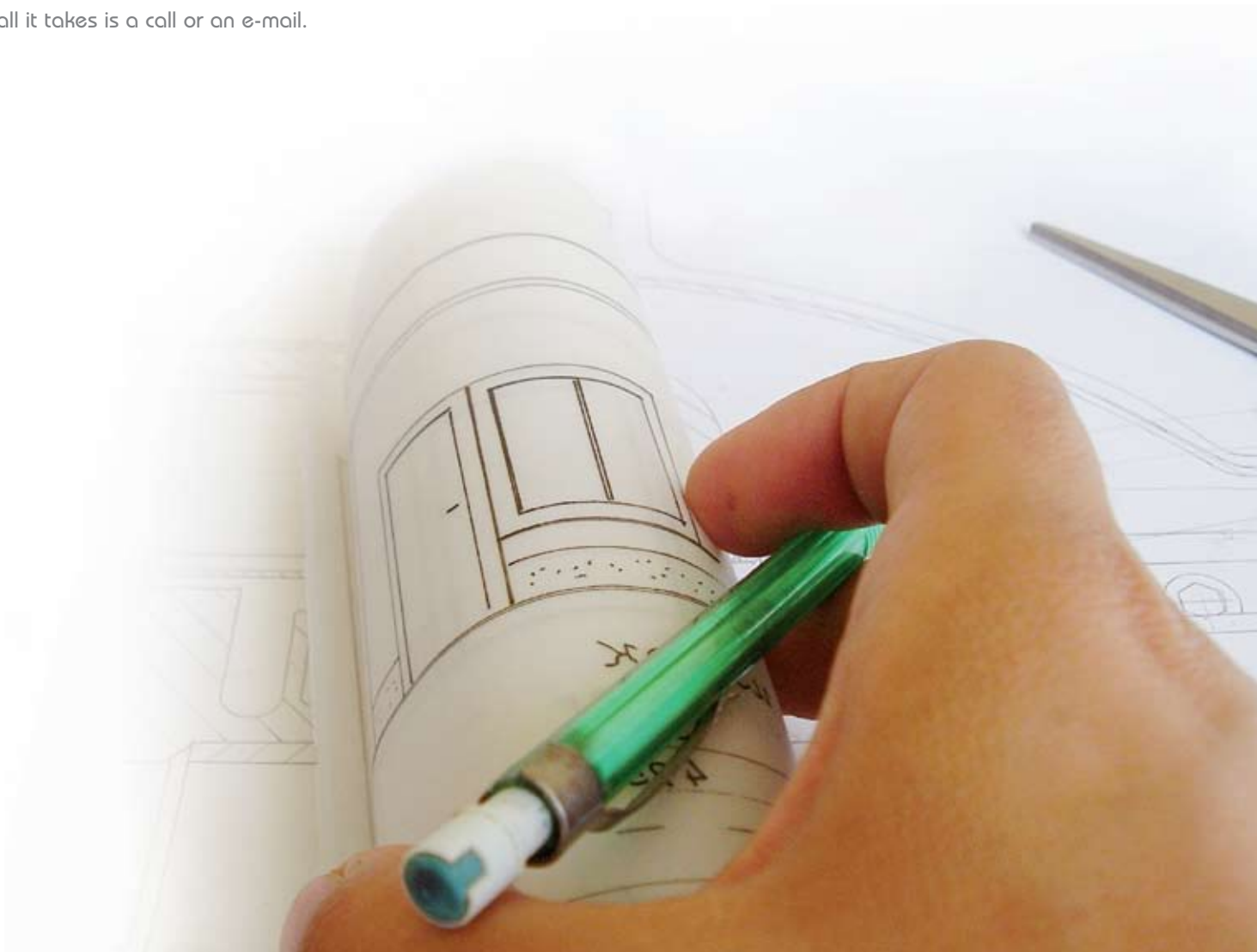

customisationrange

stand out from the crowd

From simple notices to elaborate emblems and graphics; guide, advise and remind your patrons with Urbanscape's wide selection of customisation and personalisation options.

What better way to remind citizens of your contribution to the environment than your identity being clearly visible on your public furniture? With a diverse range of customisable labels, plaques, insets, mouldings, and custom colours, Urbanscape have everything you need to project your own identity and message.

- Point people in the right direction
- Remind people where they are
- Display your identity with pride
- Style your planters and furniture to match unique surroundings



notice boards
Your corporate branding:
mould-in graphic or vinyl transfer



litter disposal
Your corporate branding:
mould-in graphic or vinyl transfer

Products can be manufactured in non-standard colours, which can be matched to NCS Natural Colour System® MUNSSELL®, RAI Design System®, PANTONE® or sample references.

A range of traditional designs are available in all popular colours and we would be happy to work with your designers if a bespoke scheme is required.



Information on the wide colour spectrum can be found on page 31



customisationrange

make the product yours

Anything is possible with Urbanscape's truly bespoke service. Our expert production team will develop a unique product range to your specifications of shape, size, colour and branding.

To discuss your specific needs and to find out more about the excellent range of customisations available, call us now.

We can incorporate your name, logo and crest to any of our products...

- Mould in Graphics
- Vinyl Transfers
- Acetate Etchings



ALL URBANSCAPE
products use
recyclable materials

URBANSCAPE The Nursery, Penfold, Hulland Village, Derbyshire DE6 3EQ, United Kingdom
T: 01335 372785 | F: 01335 372786 | E: info@urbanscapeuk.com | W: www.urbanscapeuk.com



Urbanscape products in this brochure are the subject of Intellectual Property protection, including patent applications, registered designs and copyright/design right. In addition, certain trademarks are protected by registration, while this brochure itself is protected by copyright.

Urbanscape will take appropriate action to enforce these rights in respect of any infringement of their intellectual property.

